

Paper LEGO Forestman instructions

step 1

glue
toothpick
X-Acto knife
small metal rod
rubber cutting mat

parts printed on thicker paper
H2 (200 gsm)

Because of the wear and tear on the joints of taking a part and putting back together the "mini"fig, I really recommend using thicker paper for this model.
Other than that, you can use any tools you normally use, of course. Have fun building! ;o)

step 2

After cutting out part H1 (don't forget the three small slits on top!) pre-shape^o the part and then glue it together as shown here.
For the best result, you can "edge-colour"^{**} the parts as well, but that's completely optional.
^o www.tinyurl.com/preshaping
^{**} www.tinyurl.com/edgecolouring

step 3

Glue part H2 into a ring, and then glue it to the open end of the head.

step 4

Glue part H3 into a hollow cylinder (with the coloured side in!) and then glue part H4 to the open end (after cutting out the center first!)

step 5

Take your time to glue parts H3+H4 to the open end of the head as shown here.

step 6

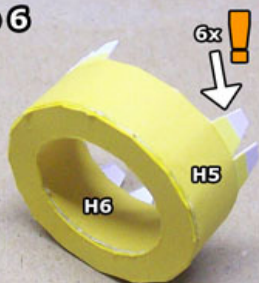

Cut out and assemble part H5, but don't score or fold the 6 larger glueing tabs!

Next, glue part H6 into a ring with the coloured side in, and glue it underneath the hole on part H6.

step 7

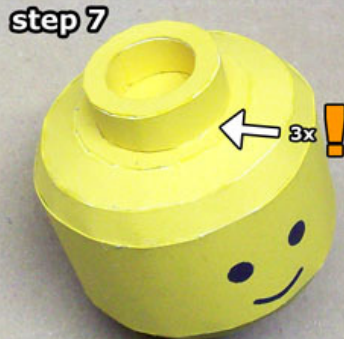

Now glue parts H5 and H6 on top of the head, by pushing the glueing tabs through the 3 small slits.

step 8

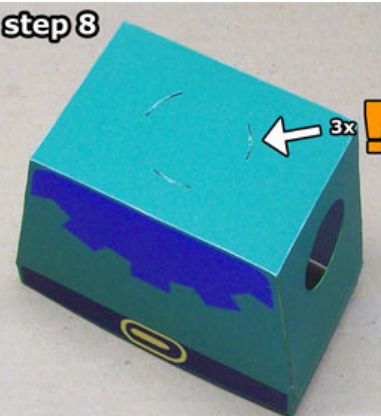

Cut out the 2 holes on the sides and the 3 small slits on top of part T1, and then assemble it as shown here.

step 9

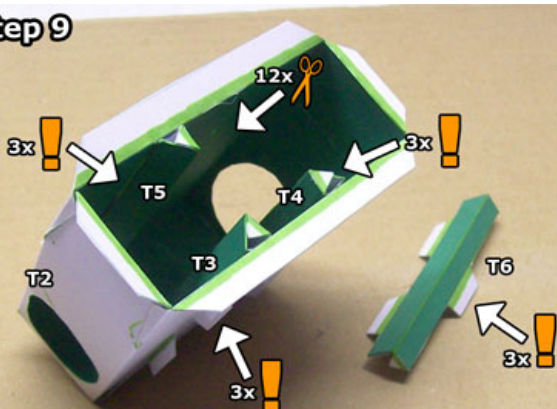

Cut out the 2 holes and the 12 small slits on part T2, and then assemble the part with the coloured side in, as shown here.

Then cut out parts T3-T6, and push the larger glueing tabs through the slits on part T2 to glue them to the inside of the torso as shown here.

step 10

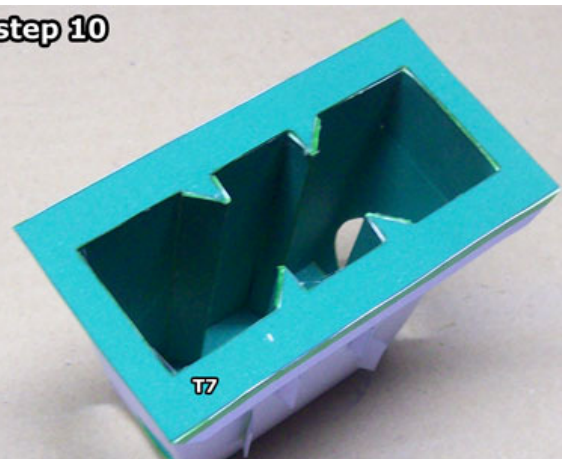

Next, cut out part T7 and glue it underneath the inside of the torso as shown here.

step 11

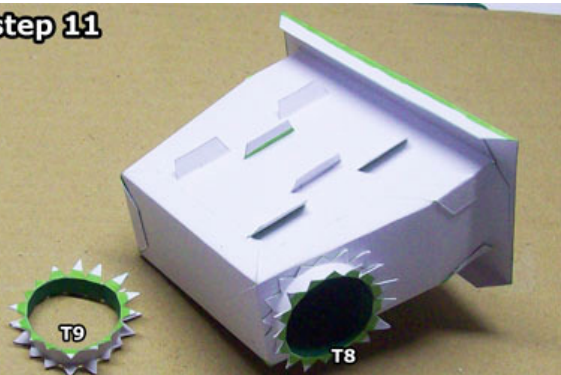

Now glue parts T8 and T9 into rings (with the coloured side in!) and then glue them over the holes on the sides of the torso.

step 12

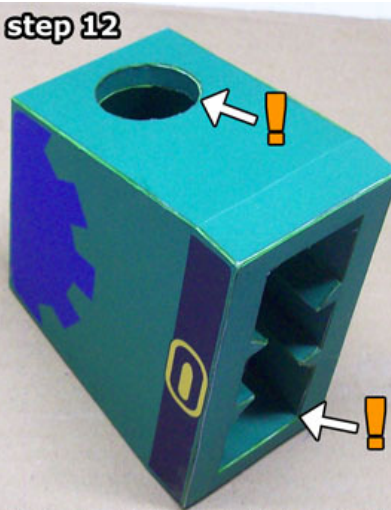

Next, glue the inside of the torso to the inside of part T1.

Take your time to properly align the bottom and the holes on the sides.

step 13

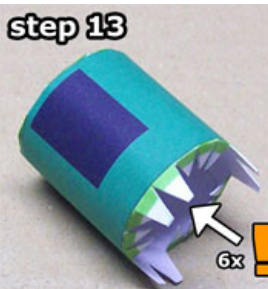

Cut out and assemble part T10 (but don't score or fold the 6 bigger glueing tabs!)

step 14

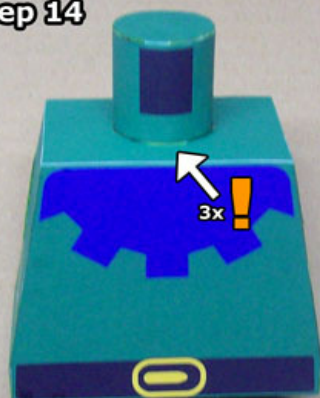

...and then glue it on top of the torso as shown here, by pushing the glueing tabs through the 3 small slits.

step 15



Cut out and glue together part LA1.

step 16



Do the same with part LA2...

step 17



...and then glue the two parts together as shown here.

step 18



Next, take your time to glue on part LA3 (don't forget to cut the three small slits!)

step 19



Glue part LA4 into a hollow cylinder (with the coloured side in!) and then glue part LA5 over the open end (after cutting out the center of course!)

step 20



Take your time to glue parts LA4 and LA5 into the open end of the arm.

step 21

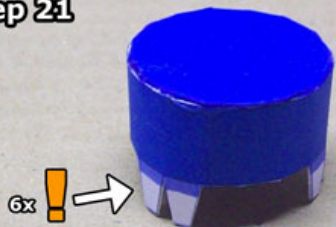

Cut out and assemble part LAG, but don't score or fold the 6 larger glueing tabs.

step 22

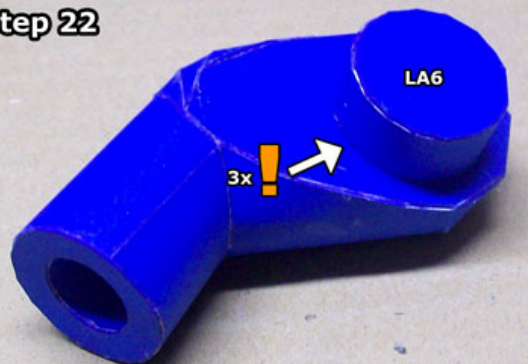

Push the glueing tabs through the slits on part LA3 to glue part LA6 to the arm.

step 23



The right arm (parts RA1-RA6) goes together the same way as the left arm, only mirrored of course.

step 24



Don't forget to cut the three slits on the back of part RH1, then make sure to properly pre-shape* the sides, and then first glue together the two ends as shown here.

* www.tinyurl.com/preshaping

step 25



Take your time to glue the flat bottom of the hand to the sides first, shaping the hand into a "U"...

step 26



...and then the beveled top, as shown here.

step 27



Next, cut out part RH2 and glue it into a hollow cylinder as shown here (don't score or fold the bigger glueing tabs!)

step 28



Push the glueing tabs through the slits on the back of the hand to glue the two parts together.

step 29



The left hand (parts LH1 and LH2) goes together the same way as the right hand (only mirrored, of course!)

step 30

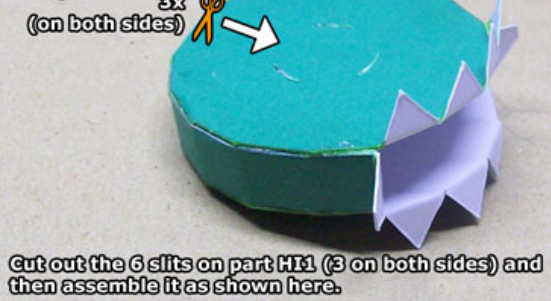

Cut out the 6 slits on part HI1 (3 on both sides) and then assemble it as shown here.

step 31

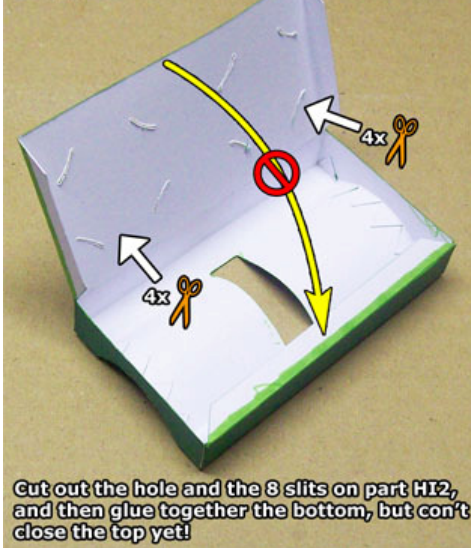

Cut out the hole and the 8 slits on part HI2, and then glue together the bottom, but don't close the top yet!

step 32

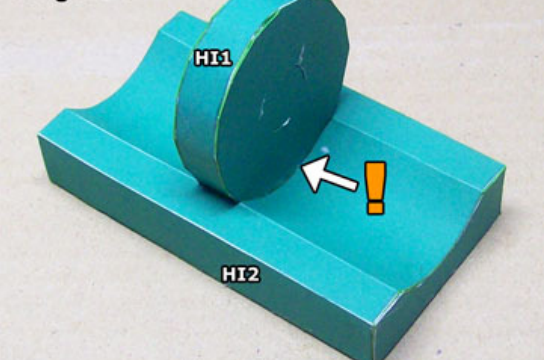

That way, you can still reach inside to glue part HI1 over the hole on part HI2 using the glueing tabs. After that, you can close part HI2 as shown here.

step 33

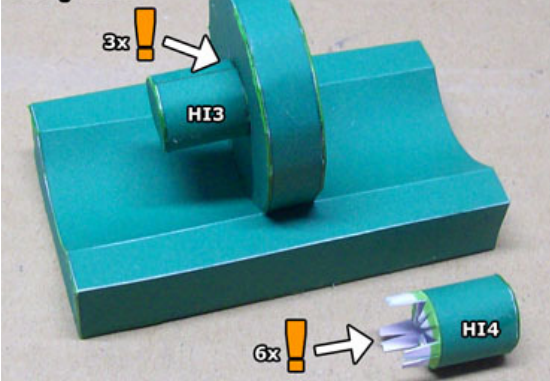

Now glue parts HI3 and HI4 into hollow cylinders (don't score or fold the larger glueing tabs!) and then glue them to the groin disc by pushing the glueing tabs into the small slits.

step 34

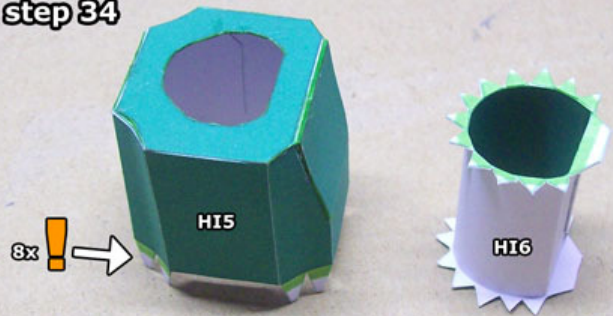

Cut out and assemble part H15, but don't score or fold the bigger glueing tabs.

Then, pre-shape part H16 and assemble it as well (with the coloured side in!)...

step 35

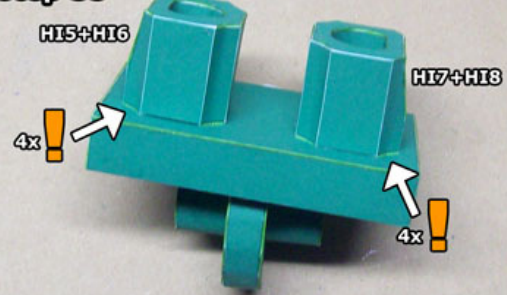

...then glue part H16 underneath the hole on part H15 and glue them on top of the hips by pushing the glueing tabs through the small slits.

Do the same for parts H17 and H18 (only mirrored, of course!)

step 36

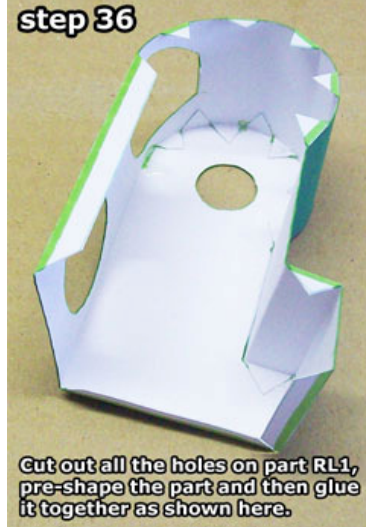

Cut out all the holes on part RL1, pre-shape the part and then glue it together as shown here.

step 37



Cut out the hole on part RL2, and then pre-shape it as shown here.

step 38

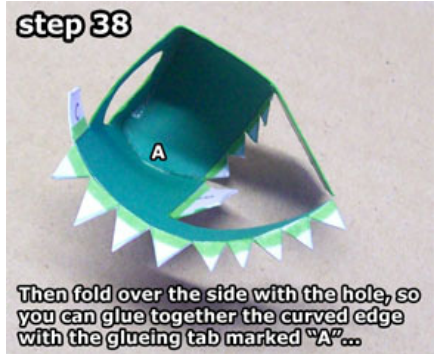

Then fold over the side with the hole, so you can glue together the curved edge with the glueing tab marked "A"...

step 39

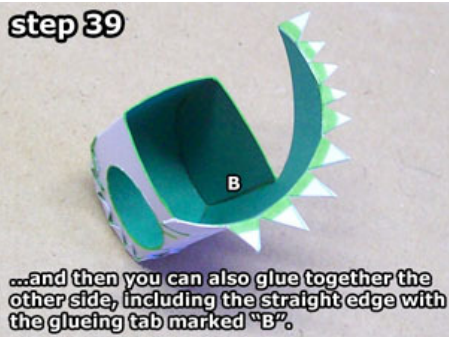

...and then you can also glue together the other side, including the straight edge with the glueing tab marked "B".

step 40

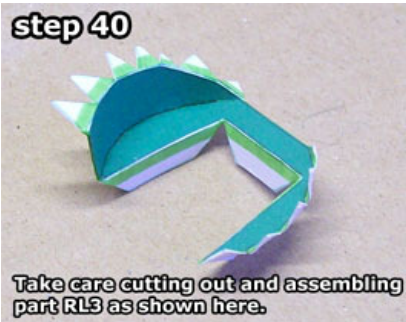

Take care cutting out and assembling part RL3 as shown here.

step 41

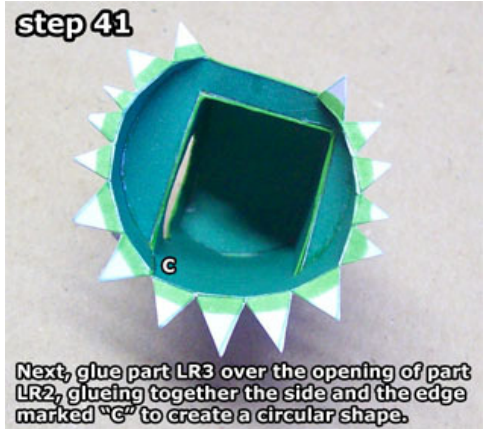

Next, glue part LR3 over the opening of part LR2, glueing together the side and the edge marked "C" to create a circular shape.

step 42



Now glue part RL4 into a cylinder (with the coloured side in!) and glue it over the hole on the side of part RL2.

step 43

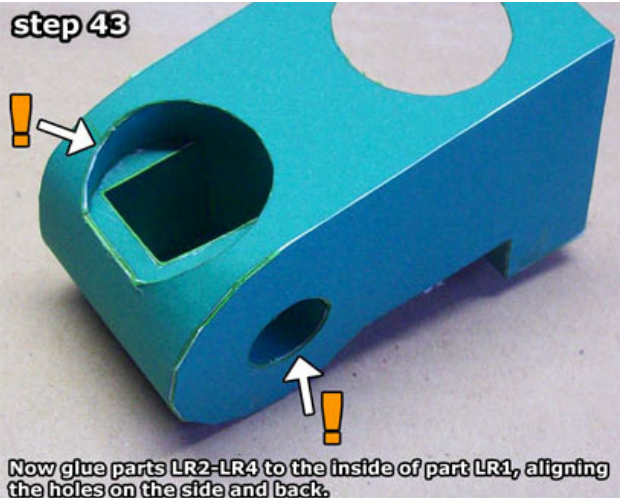

Now glue parts LR2-LR4 to the inside of part LR1, aligning the holes on the side and back.

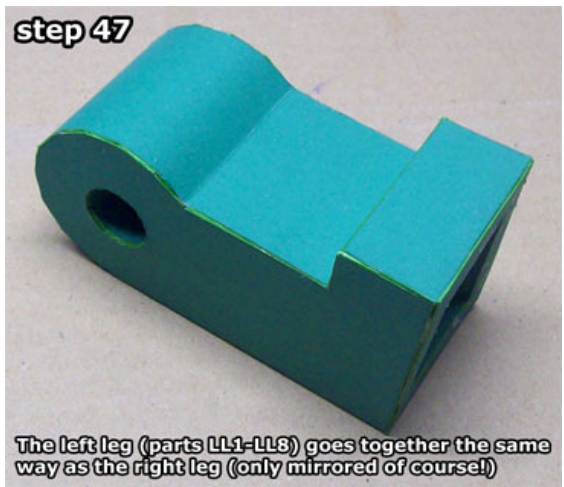
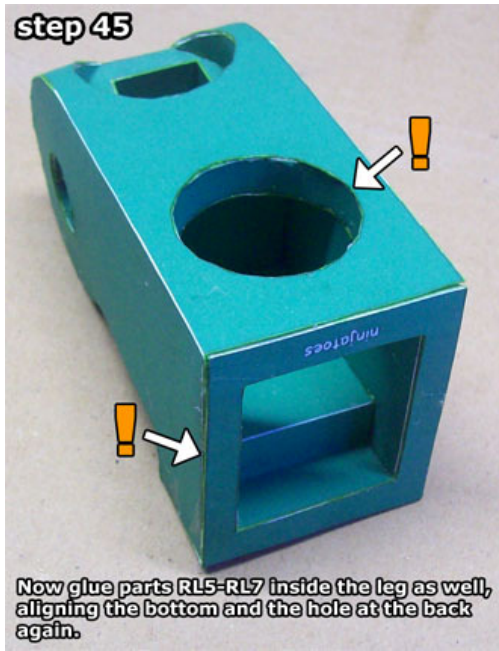
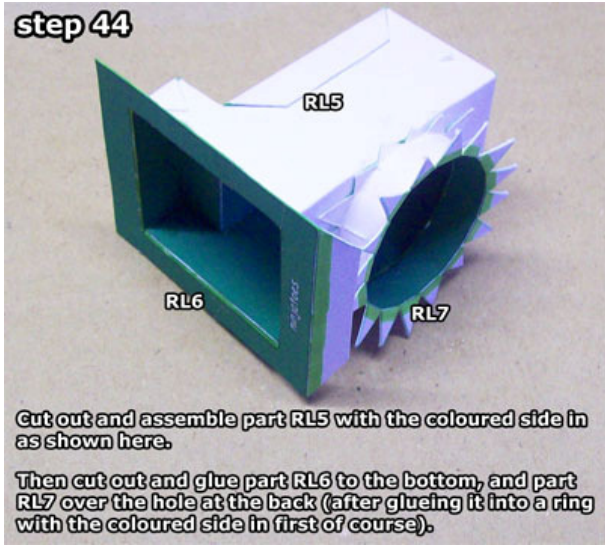

step 50



Thoroughly score the fold lines on part FE2 (but don't score or fold the bigger glueing tabs!) so it will be easier to even fold the smallest glueing tabs when glueing together part FE2 as shown here.

step 51



Likewise, thoroughly score all the fold lines on part FE3 (but not the larger glueing tabs!) so it will be easier to glue it to the underside of part FE2 as shown here.

step 52

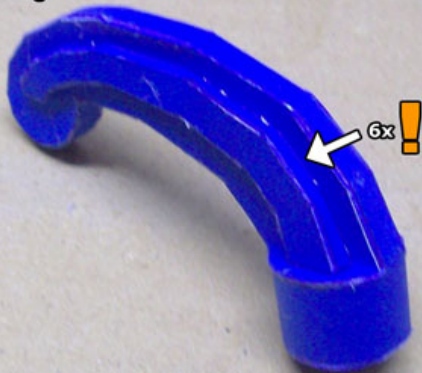

Glue parts FE2 and FE3 to to the side of part FE1 by pushing the glueing tabs through the slits.

step 53

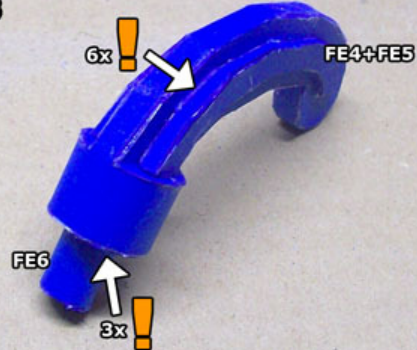

Do the same for parts FE4 and FE5 on the other side.

Then glue together part FE6 into a small cylinder (don't score or fold the bigger glueing tabs) and then glue it to the bottom of the feather by pushing the glueing tabs into the small slits.

step 54

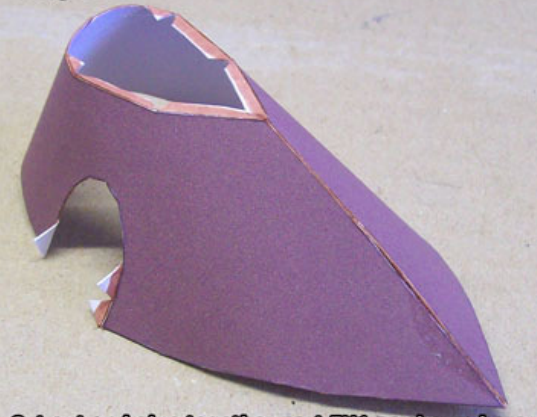

Cut out and glue together part FH1 as shown here.

step 55

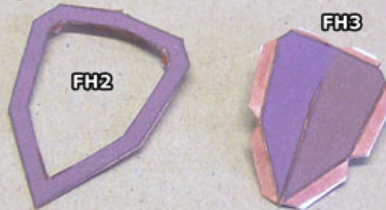

Cut out parts FH2 and FH3 (glue together part FH3 so that it's kind of a hollow disc)...

step 56



...and then glue them to the open top of part FH1.

step 57



Cut out and assemble part FH4 as shown here.

step 58

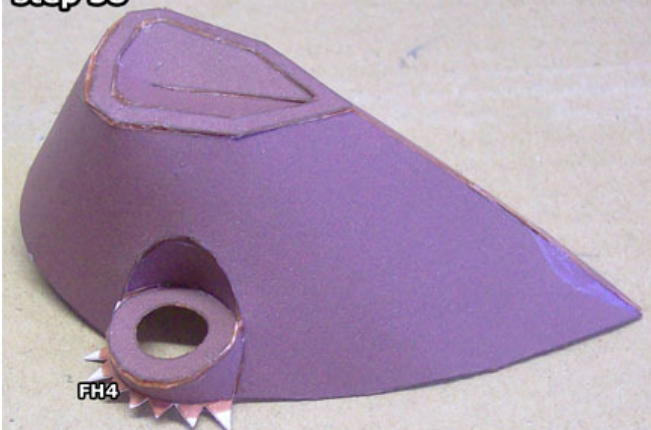

Now glue part FH4 to the elliptical hole on the side of the Forestman's hat.

step 59

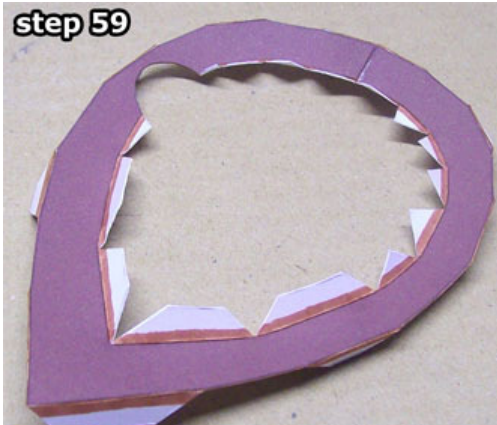

Glue together the ends of part FH5 to make a (hollow!) ring...

step 60

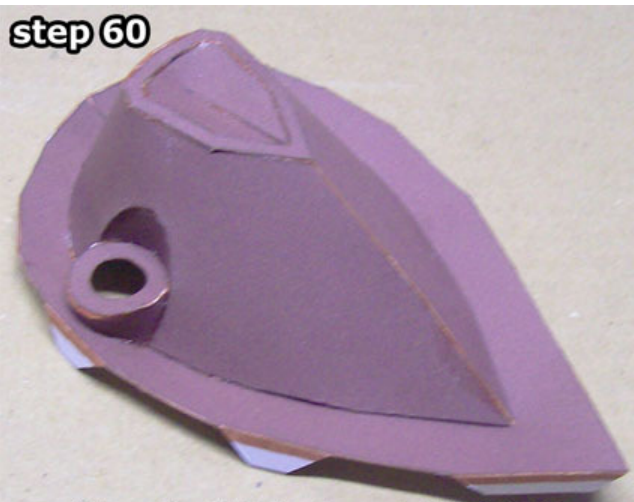

...and then glue that ring to parts FH1-FH4 like so.

step 61

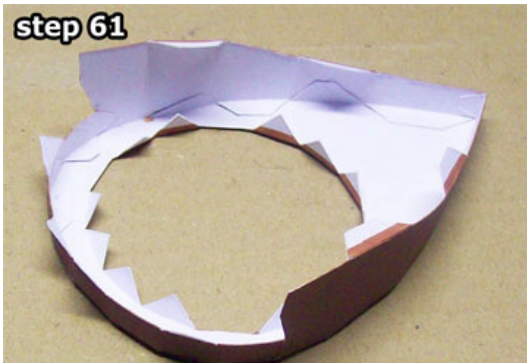

Next, cut out part FH6 and glue together the sides.

step 62

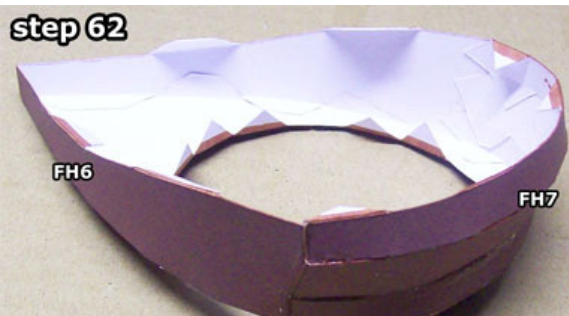

Then glue part FH7 to the back as shown here.

step 63

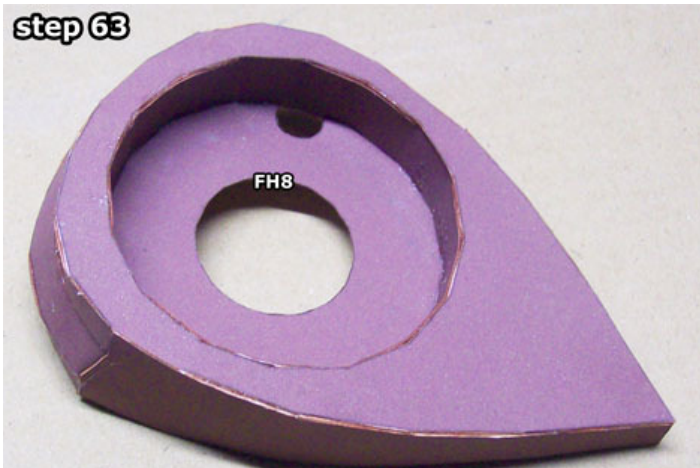

Cut out the hole on part FH8 and glue it together with the coloured side in. Then glue it over the hole on part FH6 as shown here.

step 64



Then cut out and glue together part FH9 (again with the coloured side in!) and glue it over the hole on part FH8.

step 65



Cut out and assemble part FH10. The little flap partially closes off one end as shown here.

step 66

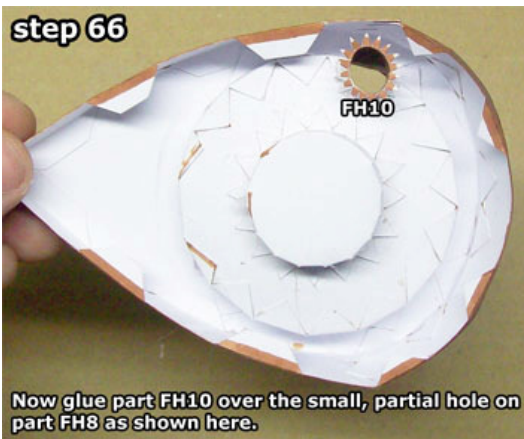

Now glue part FH10 over the small, partial hole on part FH8 as shown here.

step 67

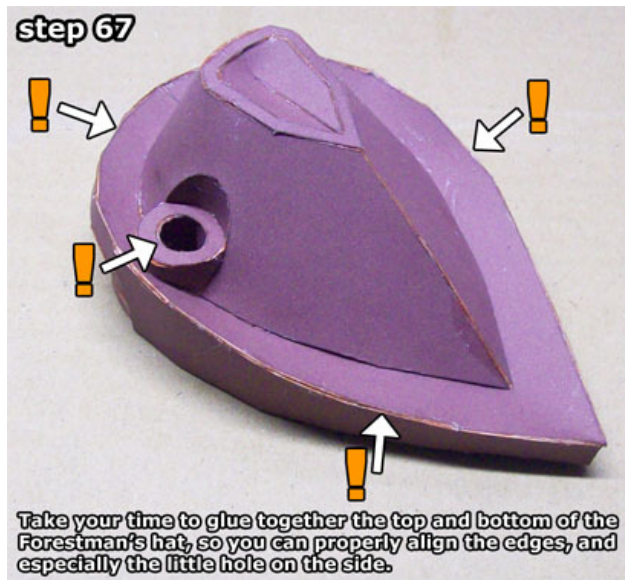

Take your time to glue together the top and bottom of the Forestman's hat, so you can properly align the edges, and especially the little hole on the side.

step 68



First, cut out and fold part QU1. Then glue part QU2 into a box (with the coloured side in!) and glue it over the rectangular hole on part QU1.

Then glue part QU3 into a ring (again with the coloured side in!) and glue it over the circular hole on part QU1.

step 69



Cut out the slits on part QU4, and then assemble it into a box as shown here.

step 70



Glue part QU4 over part QU2 as shown here. Don't worry, those small parts are supposed to stick out like that!

step 71

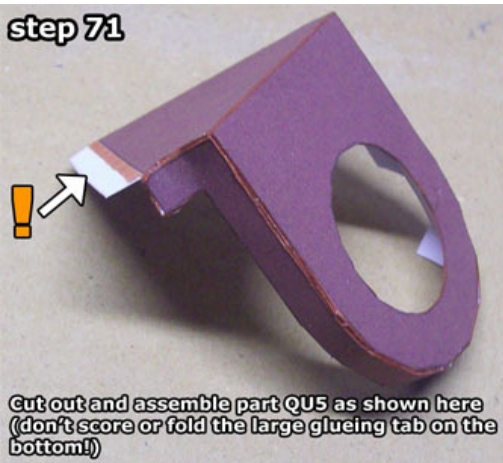

Cut out and assemble part QU5 as shown here (don't score or fold the large glueing tab on the bottom!)

step 72

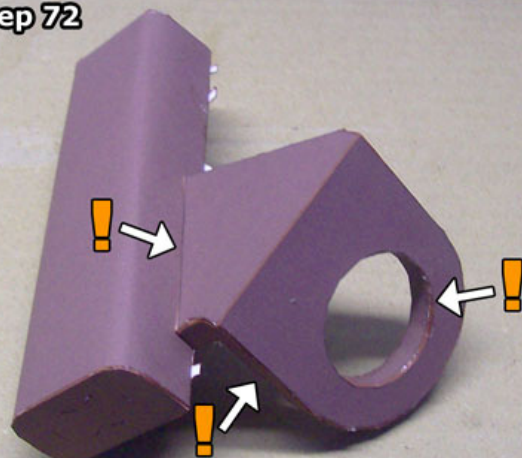

Take your time glueing part QU5 to the rest of the arrow quiver by aligning the edges and pushing the large glueing tab through the slit on part QU4.

step 73

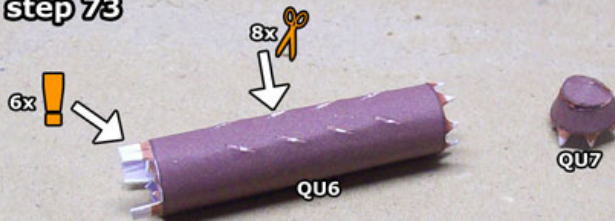

Glue part QU6 into a cylinder with a flat backside (don't score or fold the bigger glueing tabs and don't forget to cut the 8 small slits!) and glue part QU7 into a small dome.

step 74

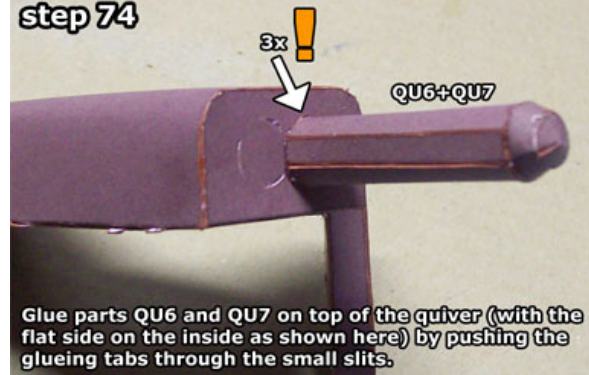

Glue parts QU6 and QU7 on top of the quiver (with the flat side on the inside as shown here) by pushing the glueing tabs through the small slits.

step 75

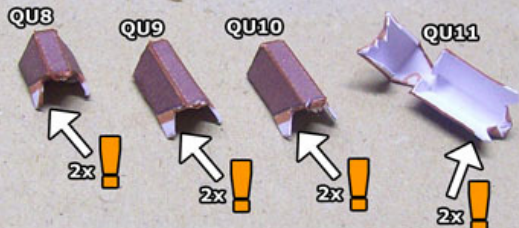

Now cut out and assemble parts QU8-QU11 as shown here (don't score or fold the bigger glueing tabs!)

step 76

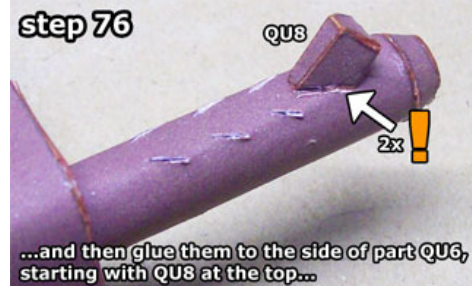

...and then glue them to the side of part QU6, starting with QU8 at the top...

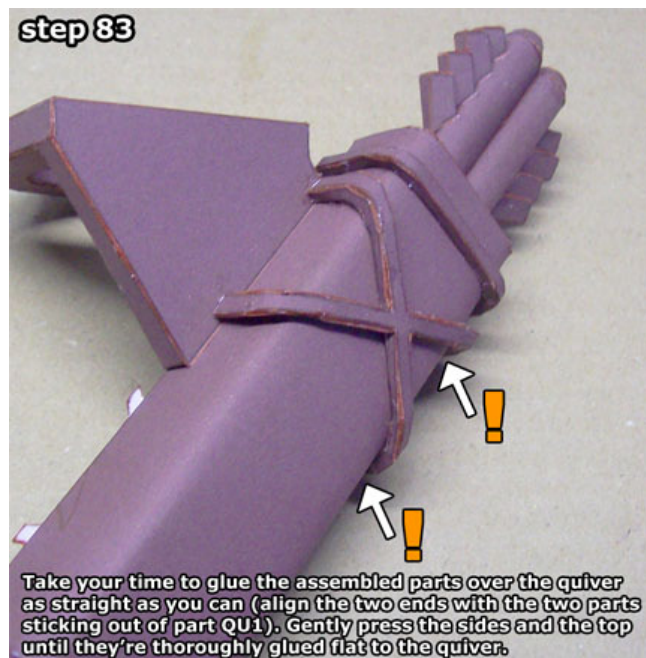
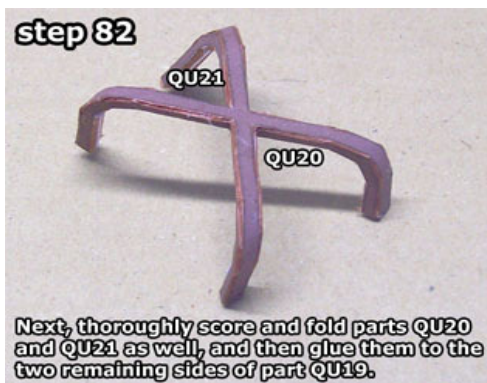
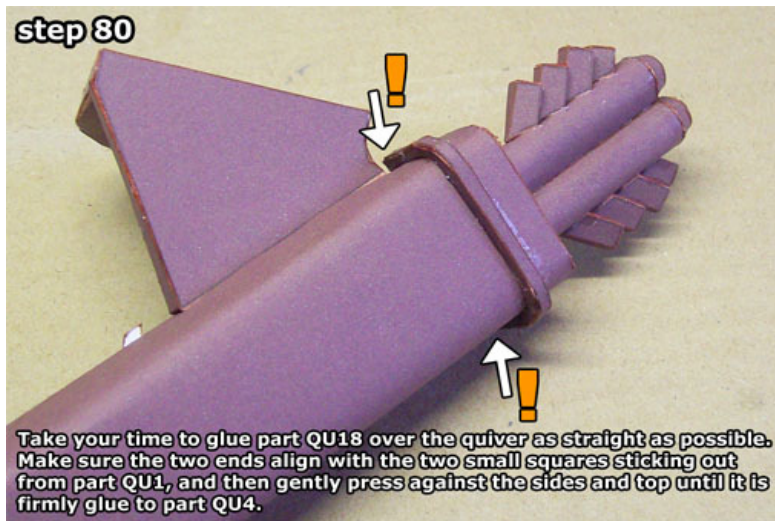

step 84

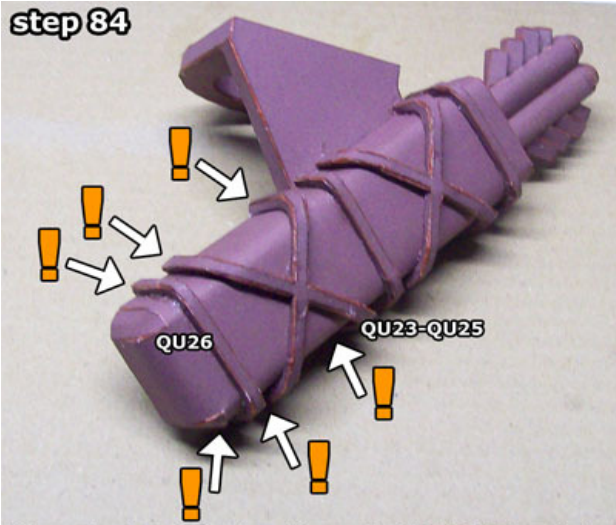

Now cut out and glue together parts QU23-QU26 and glue them to the quiver as shown here.

step 85

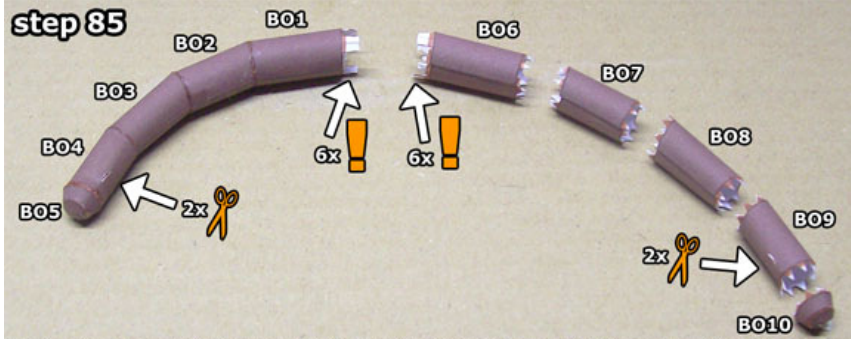

Cut out and assemble parts B01-B010 as shown here. Don't score or fold the larger glueing tabs on parts B01 and B06, and don't forget to cut the slits on parts B05 and B010!

step 86

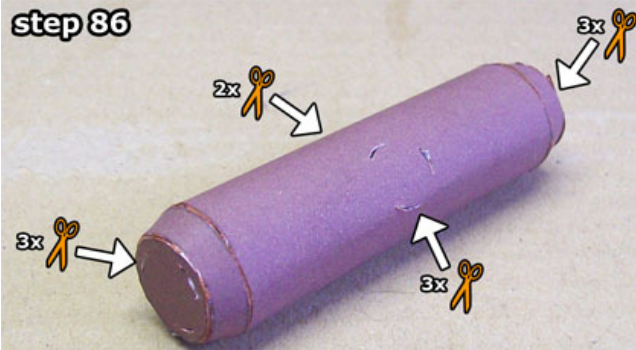

Cut all the small slits on part B011 and then assemble it as shown here.

step 87



Now glue the two arms you built before to part B011 as shown here.

step 88

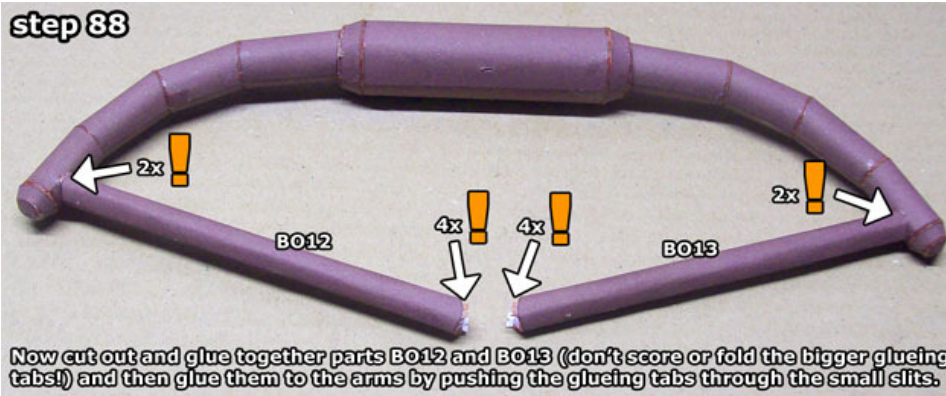

Now cut out and glue together parts B012 and B013 (don't score or fold the bigger glueing tabs!) and then glue them to the arms by pushing the glueing tabs through the small slits.

step 89

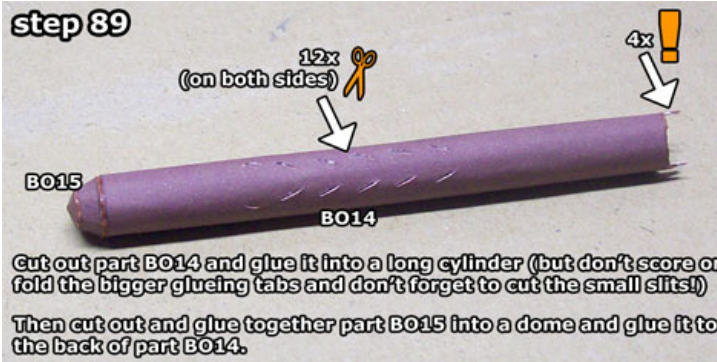

Cut out part B014 and glue it into a long cylinder (but don't score or fold the bigger glueing tabs and don't forget to cut the small slits!)
Then cut out and glue together part B015 into a dome and glue it to the back of part B014.

step 90

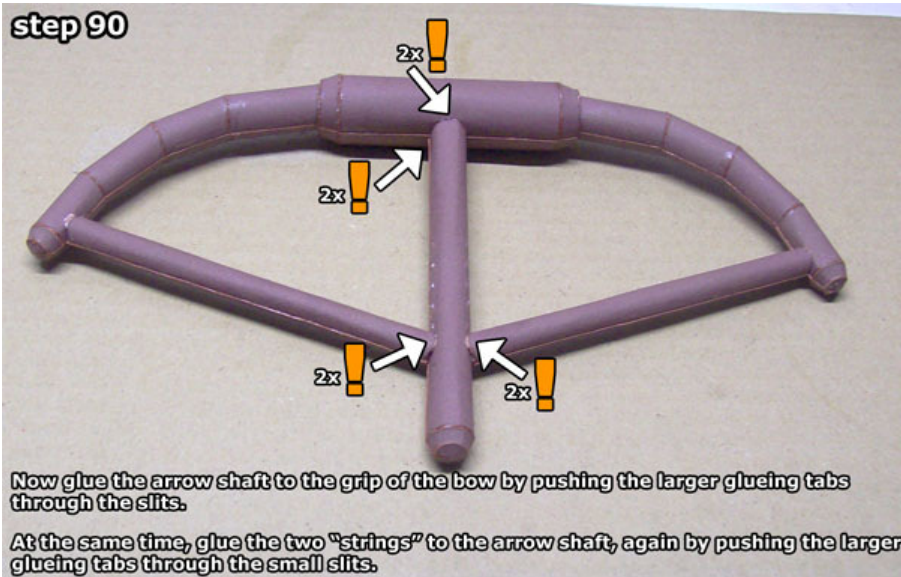

Now glue the arrow shaft to the grip of the bow by pushing the larger glueing tabs through the slits.

At the same time, glue the two "strings" to the arrow shaft, again by pushing the larger glueing tabs through the small slits.

step 91

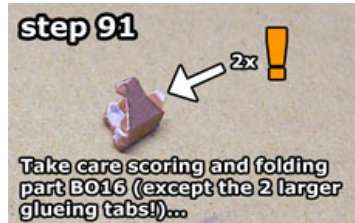

Take care scoring and folding part B016 (except the 2 larger glueing tabs!)...

step 92

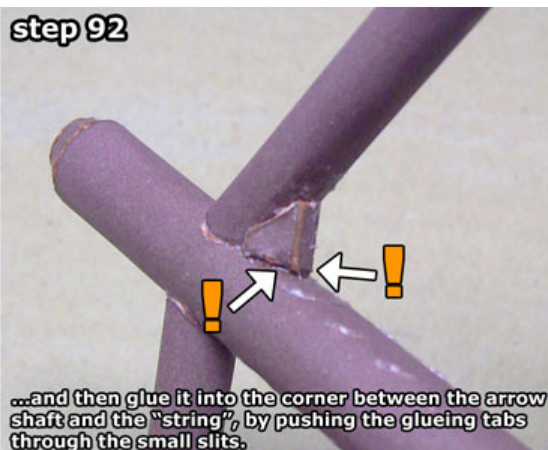

...and then glue it into the corner between the arrow shaft and the "string", by pushing the glueing tabs through the small slits.

step 93



Cut out and assemble part B017 (don't score or fold the larger glueing tabs!)...

step 94

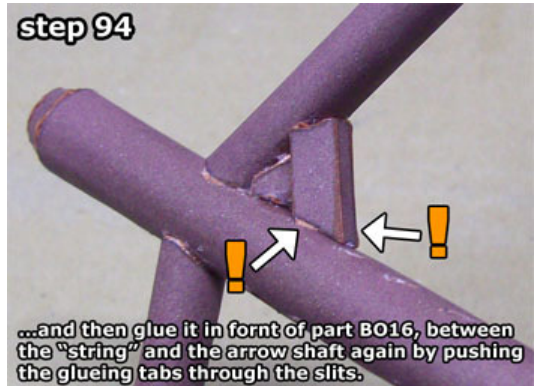

...and then glue it in front of part B016, between the "string" and the arrow shaft again by pushing the glueing tabs through the slits.

